



Hadleigh House

Rushden, Northamptonshire

oriordanbond
SALES & LETTINGS



GROUND FLOOR
454 sq.ft. (42.2 sq.m.) approx.

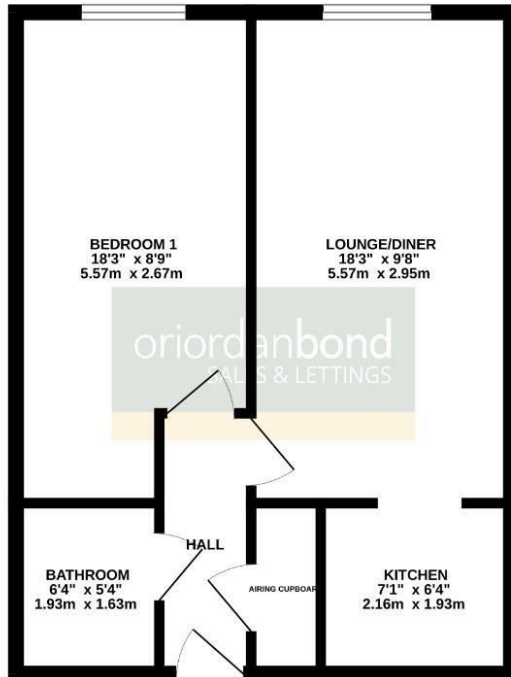

TOTAL FLOOR AREA : 454 sq.ft. (42.2 sq.m.) approx.

Whilst every effort has been made to ensure the accuracy of the floorplan contained here, measurements of doors, windows, rooms and any other items are approximate and no responsibility is taken for any error, omission or mis-statement. This plan is for illustrative purposes only and should be used as such by any prospective purchaser. The services, systems and appliances shown have not been tested and no guarantee as to their operability or efficiency can be given.
Made with floorplan 10/2020

Hadleigh House

Rushden

NN10 0AT

PRICE £67,000

Additional information

- Council Tax Band: A
- Energy Efficiency Rating: B

Viewing

Viewing strictly by appointment – details below

Disclaimer

O'Riordan Bond Estate Agents Limited has not tested apparatus, equipment, fittings or services and so cannot verify they are in working order. The buyer is advised to obtain verification from their solicitor or surveyor.

O'Riordan Bond Rushden Sales

01933 316316

rushden@oriordanbond.co.uk

